

Installation of partition board

Fixing of installation

1. Normally, the Noya Boards for partition are arranged and laid longitudinally, i.e. the longer side of Boards resting on the firm joist;

2. The butt junction of the Boards should be close naturally without strong pressing to the position;

3. The slab joint at the both sides of wall body may not be staggered if no strict requirement in fire proofing and sound insulation; the stagger joint shall keep up and down if the wall body is higher than 3 meters.

Pay special attention to arrangement of the boards at door and window, do not let them resting on the joist of door and window frames vertical or horizontal to the ground in order to avoid cracking of slab joint due to vibration produced out opening and shutting of door and window.

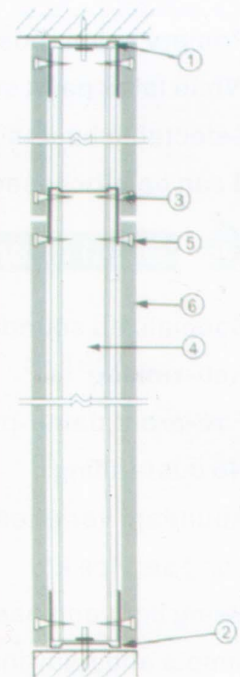
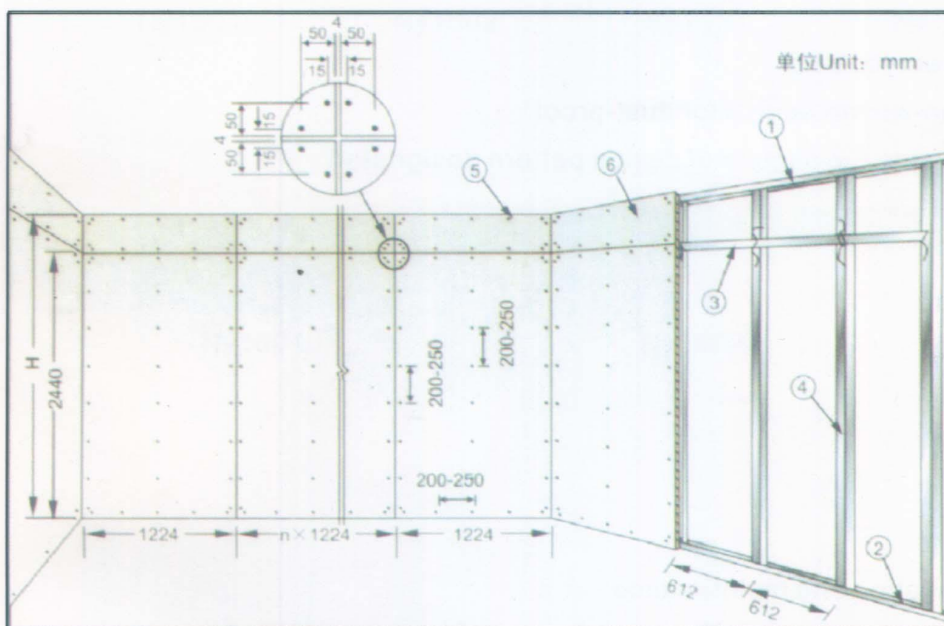

- 1、 Along top keel
- 2、 Along floor keel
- 3、 Horizontal Keel
- 4、 C-Channel
- 5、 Self-drilling Screw
- 6、 Fiber Cement Board